

The information contained herein is intended only as a general description of contemplated, but not covenant-
ed improvements to be made as part of the project. Certain of the elements shown on the plan may be future
or proposed and are not representation that said future development will occur as shown. Specific names,
locations, dimensions of any stores, entrances or improvements are not intended to be and should not be
relied upon and are subject to change, modification and deletion by Landlord or other parties and is not a
representation or warranty as to the opening or continued operation of any store named or depicted or to the
location of the stores, entrances and improvements. Landlord cannot guarantee that internal changes have
not occurred since this plan has been prepared. Landlord recommends that this space be field verified by
Tenant to insure the accuracy of the drawings. Landlord, Vintage Real Estate, LLC and their agents shall not be
responsible for any discrepancy between the dimensions reflected herein and the as-build condition.

All materials contained herein are the sole property and work product of the Landlord, Vintage Real Estate, LLC
and have been prepared by Vintage Real Estate, LLC.

This work product may not be used, disseminated, reproduced or distributed without the written permission of
Landlord, Vintage Real Estate, LLC

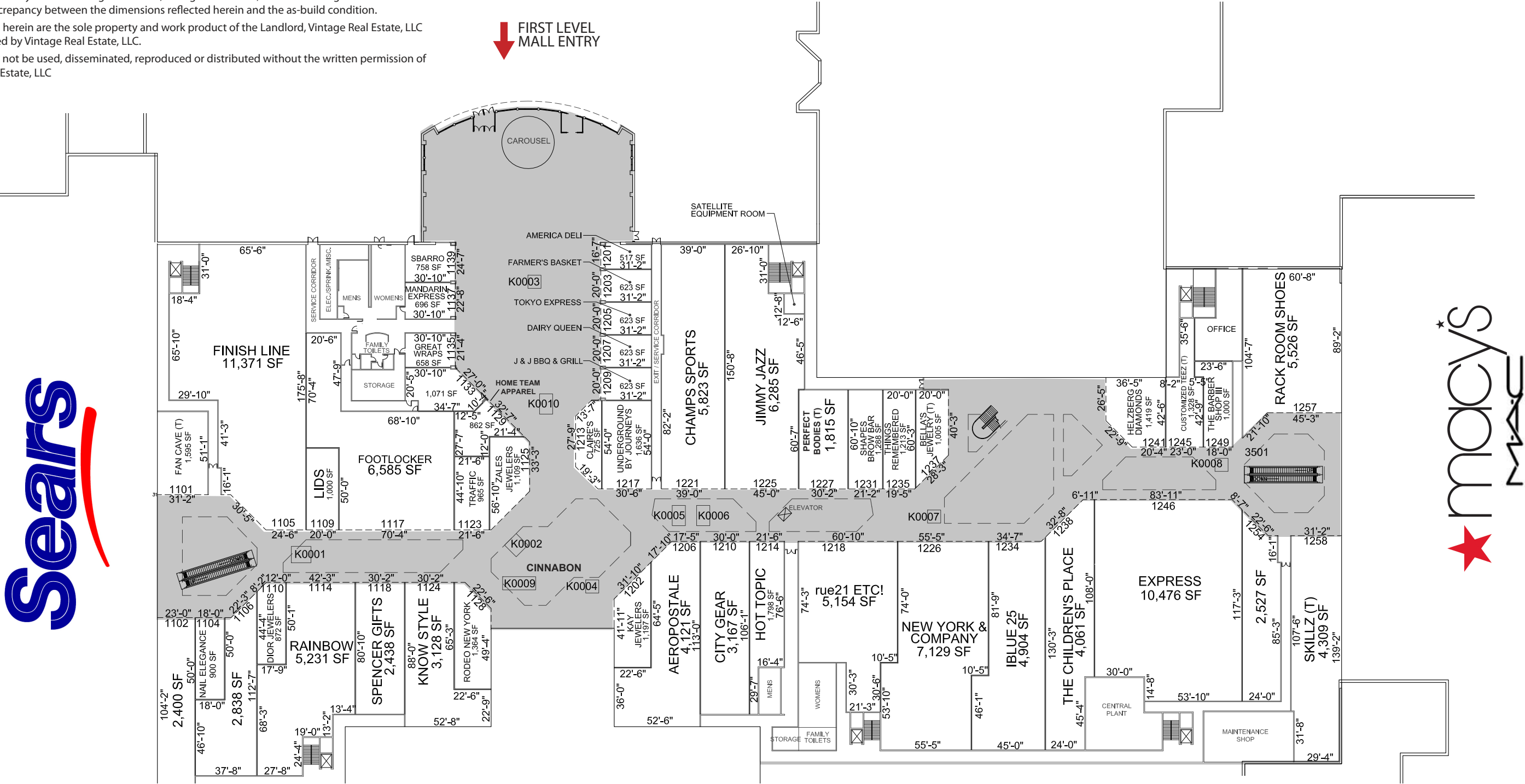

VINTAGE REAL ESTATE

A FRED SANDS COMPANY

11611 San Vicente Blvd., Suite 1000

Los Angeles, CA 90049

www.vintage-vre.com

(310) 979-9090



0' 10' 25' 50' 100'

SOUTHLAKE MALL

1000 Southlake Mall
Morrow, Georgia 30260
First Level Leasing Plan
(770) 961-1052

The information contained herein is intended only as a general description of contemplated, but not covenanted improvements to be made as part of the project. Certain of the elements shown on the plan may be future or proposed and are not representation that said future development will occur as shown. Specific names, locations, dimensions of any stores, entrances or improvements are not intended to be and should not be relied upon and are subject to change, modification and deletion by Landlord or other parties and is not a representation or warranty as to the opening or continued operation of any store named or depicted or to the location of the stores, entrances and improvements. Landlord cannot guarantee that internal changes have not occurred since this plan has been prepared. Landlord recommends that this space be field verified by Tenant to insure the accuracy of the drawings. Landlord, Vintage Real Estate, LLC and their agents shall not be responsible for any discrepancy between the dimensions reflected herein and the as-build condition.

All materials contained herein are the sole property and work product of the Landlord, Vintage Real Estate, LLC and have been prepared by Vintage Real Estate, LLC.

This work product may not be used, disseminated, reproduced or distributed without the written permission of Landlord, Vintage Real Estate, LLC

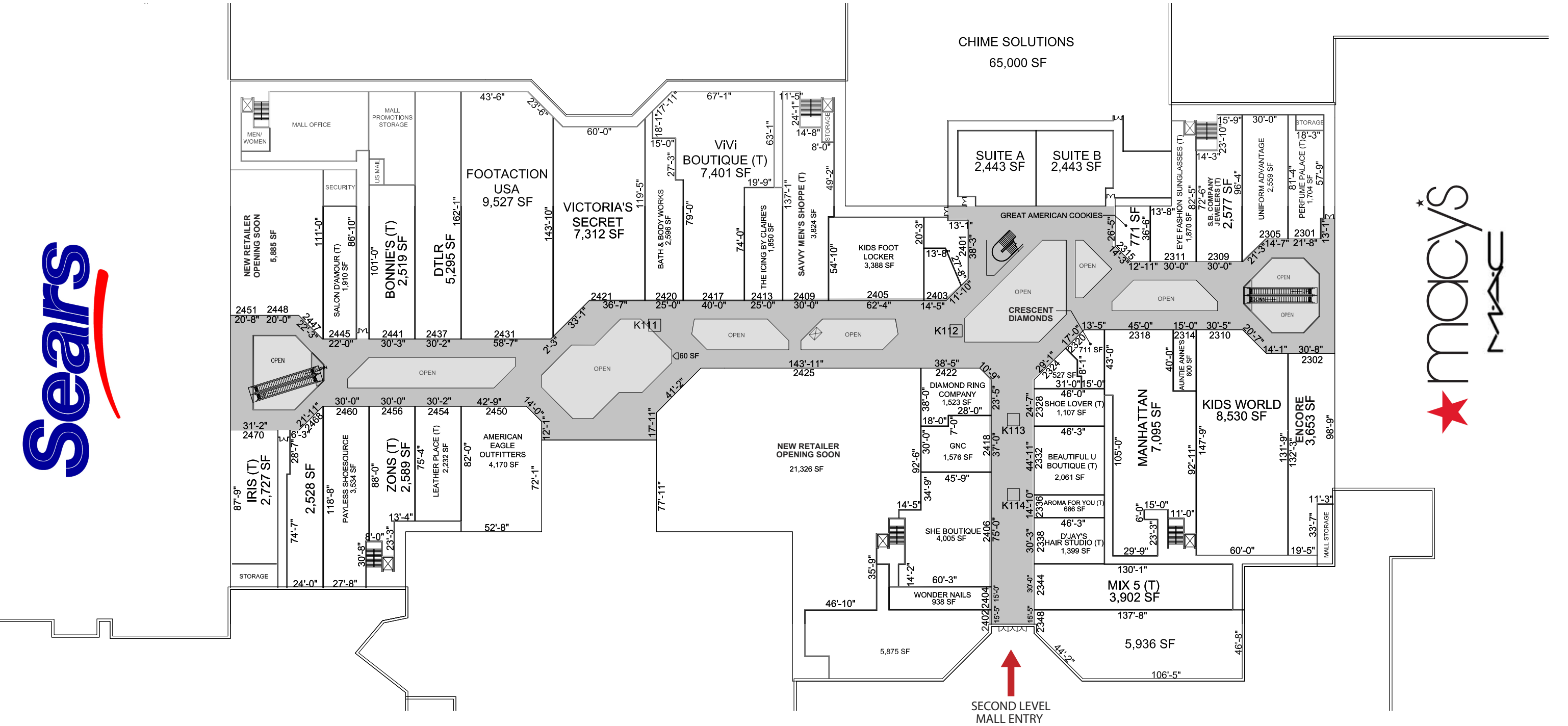

The information contained herein is intended only as a general description of contemplated, but not covenanted improvements to be made as part of the project. Certain of the elements shown on the plan may be future or proposed and are not representation that said future development will occur as shown. Specific names, locations, dimensions of any stores, entrances or improvements are not intended to be and should not be relied upon and are subject to change, modification and deletion by Landlord or other parties and is not a representation or warranty as to the opening or continued operation of any store named or depicted or to the location of the stores, entrances and improvements. Landlord cannot guarantee that internal changes have not occurred since this plan has been prepared. Landlord recommends that this space be field verified by Tenant to insure the accuracy of the drawings. Landlord, Vintage Real Estate, LLC and their agents shall not be responsible for any discrepancy between the dimensions reflected herein and the as-build condition.

All materials contained herein are the sole property and work product of the Landlord, Vintage Real Estate, LLC and have been prepared by Vintage Real Estate, LLC.

This work product may not be used, disseminated, reproduced or distributed without the written permission of Landlord, Vintage Real Estate, LLC

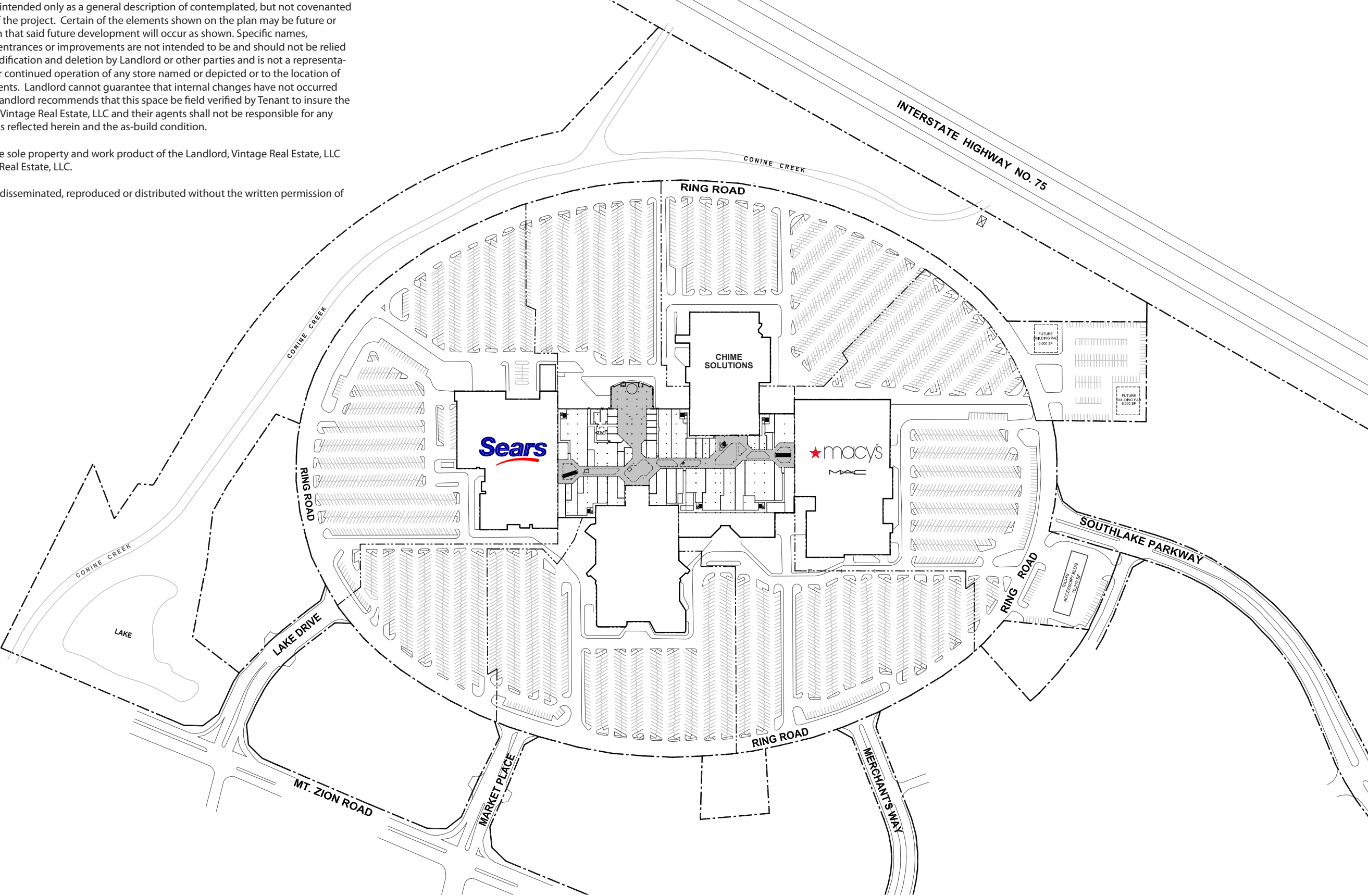

VINTAGE REAL ESTATE, LLC
11611 San Vicente Blvd., Suite 1000
Los Angeles, CA 90049
www.vintage-vre.com
(310) 979-9090



0' 50' 10' 200' 500'

SOUTHLAKE MALL
1000 Southlake Mall
Morrow, Georgia 30260
Site Plan
(770) 961-1052